



ODF 2000S Oil Smoke Filter

The Absolent type ODF 2000S Oil smoke filter features one of the most effective systems in the world for cleaning oil mist and oil smoke. The unit requires very little service.

For Absolent customers, this means extremely low life cycle costs.

The ODF 2000S filtration unit is designed for handling the most demanding applications with air flows of up to 590 cfm.

Absolent products offer a unique combination of long useful life and high collecting efficiency

The Absolent filter unit offers a long useful life as well as consistently high collecting efficiency, thanks to its design and generous filter surface measuring 344 ft². Already after the second, self-draining Absolent filter, the particle level in the air is in most cases less than 1.0 mg/m³. The ODF 2000S is equipped with a third filter stage, a so-called HEPA filter, which ensures consistent collecting efficiency. Thanks to these three filter stages, the air can usually be returned to the premises.

This means less loss of energy and more balanced ventilation in the premises.

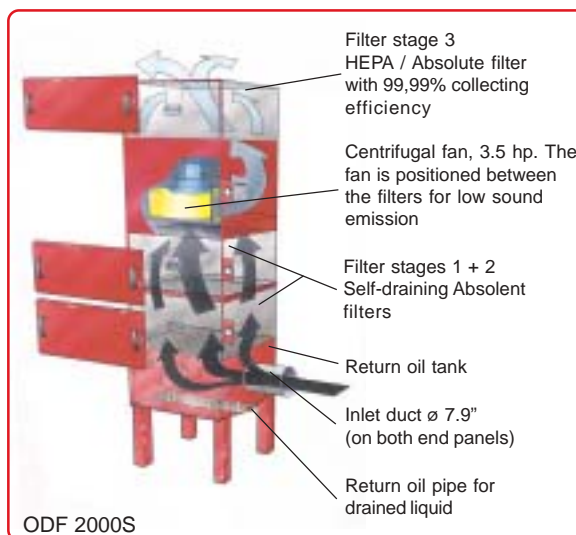

Operation

The filtering process occurs in three stages. The first and second stages consist of the self-draining Absolent filters, in which the filter material is adapted and mixed specifically for each application. The third stage consists of a HEPA filter, which has a guaranteed consistent collecting efficiency of at least 99.99% arresting 0.3 µm dia. particles. Thanks to the unique design of the filter, the Absolent ODF filter can be operated continuously without any unnecessary interruptions for draining. The return oil is collected at the bottom of the filter for recycling.

Range of Application

The Absolent ODF 2000S is well suited for use in

- Heat-Treatment
- Cold-drawing
- Gear cutting
- Grinding with straight oil
- CNC turning with straight oil
- Forging operations and cold pressing

Design

The ODF 2000S has a highly robust tower design that occupies a minimum of floor space. The ODF 2000S is supplied with a baked powder painted finish that adds colour to the shop floor.

ODF 2000S

All measurements are stated in [inch]

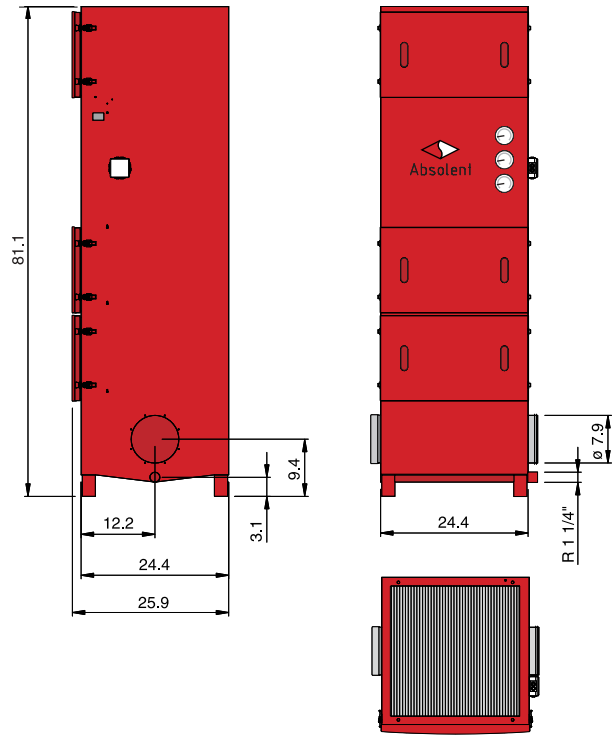

Unique filter cassettes



Absolent is one of few companies in this line of business that has specialized in the filtration of air containing wet particles. This has given us opportunity to develop a filter cassette that offers a long useful life and consistently high collecting efficiency.

Sound level¹⁾, dB(A)

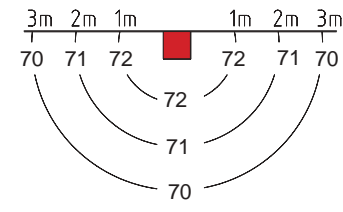



Technical Data

Max permissible air volume	590 cfm
Sound level, 1m in front of filter unit ¹⁾	72 dB(A), (see illustration)
Weight (dry filter)	485 lbs.
Available dim. external pressure drop	50 Pa
Filter area, filter 1 (Absolent filter)	55 ft ² (The area differs for various applications)
Filter area, filter 2 (Absolent filter)	70 ft ² (The area differs for various applications)
Filter area, filter 3 (HEPA-filter)	219 ft ²

Fan Data

Motor output	3.5 hp
Rated current (3-phase)	4.6 A
Power supply (3-phase)	440-480 V
Speed	3400 rpm

Color options

-  Red (RAL 3000)
 -  Grey (RAL 7032)
- Other colors can be quoted on request!*

Standard Equipment

- Pressure gauges for reading the pressure drop across the filter

Accessories

- Motor starter for fan. Either a manual or protective motor contactor (for automatic or external starting)
- Outlet hood
- Carbon filter
- Duct connections for various types of steel or plastic ductwork available on the market
- Extension legs, (standard height 400 mm)
- Water trap for various connections of the return oil pipe
- Pump unit for pumping the return oil from the filter
- Sound insulation (-3 dB)
- Extra outlet silencers (-2 dB)
- Pressure monitor, for external alarm or alarm indications with LED

¹⁾ Sound absorption in premises=1078 ft², Hemispherical sound propagation. For sound calculation concerning a specific room, contact us at Absolent or any of our dealers.



Absolent AB
Kartåsgatan 1
SE-531 40 Lidköping
Sweden
Phone: +46 (0)510-484000
Fax: +46 (0)510-484029
E-mail: info@absolent.se

Absolent Inc.
150 North Michigan Ave.
Suite 1200
Chicago, IL 60601
USA
Phone: +1 312-781 6252
Fax: +1 312 346 0683

Dealer:

Ongoing product development may subject our specifications to alteration without notice.